

Fasteners Weight Chart



HILTON STEEL
EVERYTHING WE DO IS DRIVEN BY HIGH NICKEL ALLOYS

Email:
info@hiltonhsteel.com

Phone No:
+91 9867572373



How Do You Calculate Fasteners Weight?

Calculating the weight of a fastener depends on the specification of the fastener. Let us take the volume of the stainless steel 304 fastener as 110, with the density being 7.85. Multiplying the density with the volume will determine its weight. Here $110 \times 7.85 = 863.5$

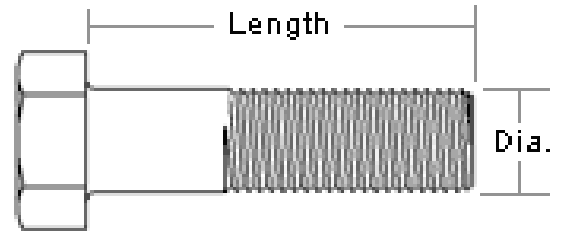

How Do You Calculate The Weight Of A Nut

To calculate the weight of a nut, the thread type, head type and length, and diameter of the bolt. You can use the same formula as a bolt to calculate its weight.

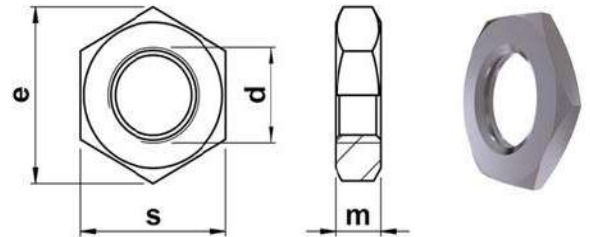

How Do You Determine The Weight Of A Stud Bolt?

The weight of a stud bolt is calculated by multiplying the volume of the product with the density. The density of a material varies from one material to the other.

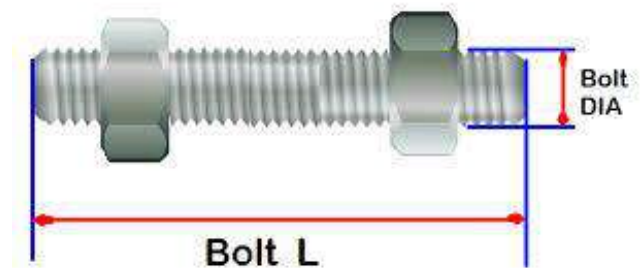

Fasteners Weight Chart

Length	Diameter in Inch								
	1/2	5/8	3/4	7/8	1	1 1/8	1 1/4	1 3/8	1 1/2
1	16.5	29.4	47.0	-	-	-	-	-	-
1 1/4	17.8	31.3	49.6	74.4	104	-	-	-	-
1 1/2	19.2	33.1	52.2	78	109	148	197	-	-
1 3/4	20.5	35.3	55.3	81.9	114	154	205	261	333
2	21.9	37.4	58.4	86.1	119	160	212	270	344
2 1/4	23.3	39.8	61.6	90.3	124	167	220	279	355
2 1/2	24.7	41.7	64.7	94.6	130	174	229	290	366
2 3/4	26.1	43.9	67.8	98.8	135	181	237	300	379
3	27.4	46.1	70.9	103	141	188	246	310	391
3 1/4	28.8	48.2	74	107	146	195	255	321	403
3 1/2	30.2	50.4	77.1	111	151	202	263	332	416
3 3/4	31.6	52.5	80.2	116	157	209	272	342	428
4	33	54.7	83.3	120	162	216	280	353	441
4 1/4	34.3	56.9	86.4	124	168	223	289	363	453
4 1/2	35.7	59	89.5	128	173	230	298	374	465
4 3/4	37.1	61.2	92.7	133	179	237	306	384	478
5	38.5	63.3	95.8	137	184	244	315	395	490
5 1/4	39.9	65.5	98.9	141	190	251	324	405	503
5 1/2	41.2	67.7	102	146	196	258	332	416	515

Fasteners Weight Chart

5/4	42.6	69.8	105	150	201	265	341	426	527
6	44	71.9	108	154	207	272	349	437	540
6 1/4	-	74.1	111	158	212	279	358	447	552
6 1/2	-	76.3	114	163	218	286	367	458	565
6 3/4	-	78.5	118	167	223	293	375	468	577
7	-	80.6	121	171	229	300	384	479	589
7 1/4	-	82.8	124	175	234	307	392	489	602
7 1/2	-	84.9	127	179	240	314	401	500	614
7 3/4	-	87.1	130	183	246	321	410	510	626
8	-	89.2	133	187	251	328	418	521	639
8 1/4	-	-	-	192	257	335	427	531	651
8 1/2	-	-	-	196	262	342	435	542	664
8 3/4	-	-	-	-	-	-	444	552	676
9	-	-	-	-	-	-	453	563	689



Fasteners Weight Chart

Check Bolt and Nut Weight Chart

Nut Weight Chart

Sizes in Inch	Heavy Hex	Square	Finished Hex	Heavy Hex Jam	Finished Jam	Heavy Square
1/2	6.54	5.78	3.75	4.00	2.62	7.87
5/8	11.9	10.8	7.33	6.96	4.93	14.3
3/4	19.3	15.4	11.9	11.0	7.70	23.5
7/8	29.7	24.5	19.0	16.7	12.0	36.2
1"	42.5	36.3	28.3	23.5	17.6	51.5
1 1/8	59.2	52.5	40.3	32.4	24.7	72.4
1 1/4	78.6	70.6	54.3	45.8	36.1	95.5
1 3/8	102	94.5	73.0	59.3	47.9	125.0
1 1/2	131	122	94.3	74.8	60.9	161
1 5/8	162			91.6		
1 3/4	204		151	114	100	
1 7/8	241			134		
2"	299		224	165	140	
2 1/4	419			227		
2 1/2	564			332		
2 3/4	738			429		
3"	950			545		
3 1/4	1194			651		
3 1/2	1526			851		
3 3/4	1812			1005		
4"	2180			1200		



How Much Does An Anchor Bolt Weight?

A size 50 M10 anchor bolt weighs 40.60 kg per 1000 pieces, with an M16 weighing 107 kg. A size 100 M10 anchor bolt weighs 71.60 kg per 1000 pieces, while M16 weighs 140 kgs.

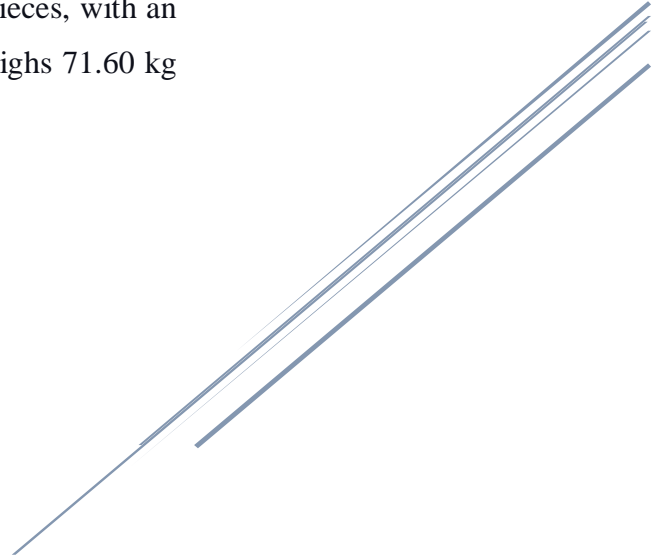
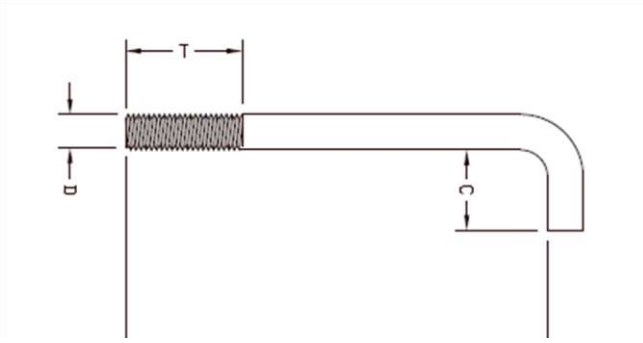

What Is The Weight Of A Screw?

The weight of a screw varies from size to size. A screw of M1x2 specification has a weight of 0.00180 kg, with M1.6x2.5 having a weight of 0.00620 per kg. As the dimension increases, the weight also increases.

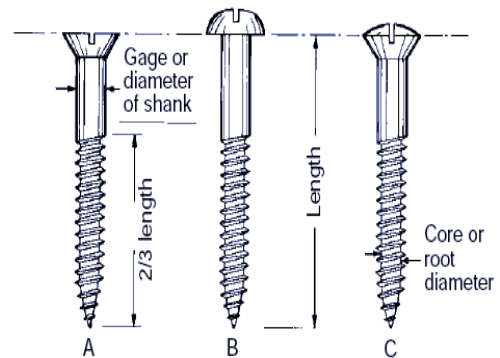

Fasteners Weight Chart

View Stainless Steel Screw and Hex Bolt Weight in Kg

Hex bolt weight chart

Length in Millimeter	Diameter									
	M 5	M 6	M 8	M 10	M 12	M 14	M 16	M 18	M 20	M 22
16	0.448	0.743	1.590	3.211						
20	0.598	0.812	1.711	3.411	4.892					
25	0.660	0.897	1.871	3.660	5.252	8.170				
30	0.737	1.010	2.070	3.912	5.574	9.690	10.707		18.657	
35	0.804	1.120	2.271	4.223	5.974	10.000	11.416	16.026	19.608	
40	0.881	1.230	2.470	4.533	6.410	10.288	12.107	16.667	20.747	
45	0.958	1.340	2.671	4.840	6.859	10.504	12.821	17.241	21.739	
50	1.030	1.450	2.870	5.155	7.299	11.261	13.624	17.857	22.727	28.409
55		1.560	3.071	5.464	7.740	11.628	14.409	18.868	23.810	30.120
60		1.670	3.270	5.774	8.183	12.255	15.244	20.000	25.126	32.051
65		1.781	3.472	6.083	8.621	12.626	16.026	21.008	26.455	34.014
70		1.890	3.671	6.394	9.058	12.987	16.835	22.124	27.778	35.461
75		2.000	3.873	6.702	9.506	13.228	17.606	23.256	29.070	39.063
80		2.111	4.072	7.013	10.000	13.889	18.248	24.510	30.303	40.000
90			4.472	7.634	10.917	14.925	19.841	26.042	33.113	41.667
100			4.873	8.251	11.820	16.340	21.459	27.778	35.714	46.296
110				8.881	12.723	17.730	23.041	31.250	38.168	47.170
120				9.506	13.624	18.797	24.631	32.895	40.984	50.000
130				10.101	14.535	20.000	26.316	34.722	43.478	52.632
140				10.707	15.432	20.833	27.933	35.461	46.296	55.556
150				11.312	16.340	22.222	29.412	37.594	48.544	58.824
160				11.905	17.241	24.272	31.056	40.984	50.505	61.728
170				12.500	18.116		32.680		53.191	64.935
180				13.123	19.011	26.882	34.247		55.556	67.568
190				13.736	19.920		35.971		58.140	70.423
200				14.327	20.833	29.586	37.594	49.020	60.976	73.529
220				15.528	22.624		40.650		65.789	79.365
240				16.722	24.510		43.860		71.429	84.746
250				17.301	25.381		45.455		74.627	87.719
260				17.921	26.316		47.170		76.923	90.909
280				19.157	28.090		50.505		81.967	98.039
300				20.325	29.940		53.763		87.719	104.167
320					31.646		56.818		92.593	
340					33.557		60.241		98.039	

Fasteners Weight Chart

screw weight chart

DIAMETER \ LENGTH	4	5	6	8	2	3	10	12	35	40	45	50
M4			0.111	0.126			0.141	0.157	0.349	0.380	0.417	0.457
M5			0.206	0.220			0.255	0.280	0.562	0.625	0.688	0.750
M6				0.356			0.392	0.427	0.825	0.920	1.000	1.090
M1.6	0.009	0.010	0.011	0.014	0.007	0.008	0.016	0.018				
M2	0.017	0.019	0.021	0.025		0.016	0.029	0.032				
M2.5	0.030	0.033	0.036	0.042		0.027	0.048	0.054				
M3			0.060	0.069			0.078	0.087	0.188	0.210	0.232	0.254
M8							0.785	0.849	1.580	1.740	1.890	2.060
M10								1.460	2.610	2.860	3.110	3.360

DIAMETER \ LENGTH	55	60	65	14	16	20	25	30	70	80	90	100
M4	0.471	0.490		0.172	0.188	0.219	0.258	0.296	0.566	0.642	0.718	
M5	0.810	0.875		0.305	0.330	0.378	0.440	0.502	1.000	1.130	1.255	1.380
M6	1.170	1.260		0.462	0.498	0.569	0.656	0.745	1.430	1.600	1.770	1.940
M1.6				0.020	0.023							
M2				0.036	0.040	0.047						
M2.5				0.060	0.066	0.078						
M3	0.276	0.298		0.096	0.104	0.122	0.144	0.166				
M8	2.210	2.390		0.913	0.977	1.100	1.260	1.420	2.700	3.010	3.330	3.650
M10	3.610	3.860	4.130	1.560	1.660	1.860	2.110	2.360	4.400	4.860	5.350	5.850



Fasteners Weight Chart

Check Socket Head Cap Screw And Stud Bolts And Nuts Weight Chart

Socket Head Cap Screw Weight Chart

LENGTH\DIAMETER	M4	M5	M6	M2	M3	M8	M10	M12	M20
3				0.0155					
4				0.0175					
5				0.0195	0.067				
6	0.150			0.0215	0.071				
8	0.165	0.245		0.0255	0.080				
10	0.180	0.270	0.470	0.0295	0.088				
12	0.195	0.295	0.507	0.0355	0.096	1.09			
16	0.225	0.345	0.575	0.0415	0.116	1.21	2.09		
20	0.265	0.401	0.653	0.0495	0.136	1.34	2.29	3.21	
25	0.315	0.478	0.759		0.161	1.50	2.54	3.57	
30	0.365	0.555	0.830		0.186	1.69	2.79	3.93	12.8
35	0.415	0.632	0.991			1.89	3.04	4.29	13.9
40	0.465	0.709	1.100			2.09	3.29	4.65	15.0
45		0.786	1.210			2.29	3.61	5.01	16.1
50		0.863	1.320			2.49	3.93	5.45	17.2
55			1.430			2.69	4.25	5.89	18.3
60			1.540			2.89	4.57	6.34	19.4
65						3.10	4.89	6.78	20.5
70						3.30	5.21	7.13	21.6
80						3.70	5.85	8.02	24.1
90							6.49	8.91	26.6
100							7.12	9.80	29.1
110								10.70	31.6
120								11.60	34.1
130									36.6
140									39.1
150									41.6
160									44.1
180									49.1

Fasteners Weight Chart

200	54.1
220	
240	
260	
280	
300	

LENGTH\DIAMETER	M24	M30	M36	M42	M14	M16	M48	M56	M64
3									
4									
5									
6									
8									
10									
12									
16									
20									
25					4.80	7.13			
30					5.30	7.78			
35					5.80	8.44			
40	27.0				6.30	9.10			
45	28.5	50.0			6.80	9.76			
50	30.0	52.7			7.30	10.60			
55	31.6	55.4	87		7.80	11.40			
60	33.0	58.1	91	137	8.40	12.20			
65	34.5	60.8	95	142	9.00	13.00			
70	36.3	63.5	99	147	9.60	13.80	204		
80	39.9	69.0	107	158	10.80	15.40	218	334	
90	43.5	74.5	115	168	12.00	17.00	232	353	522
100	47.1	80.0	123	179	13.20	18.6.	246	372	547
110	50.7	85.5	131	189	14.40	20.20	260	392	573
120	54.3	91.0	139	200	15.60	21.80	274	411	598
130	57.9	96.5	147	210	16.80	23.40	288	430	623
140	61.5	102	155	221	18.00	25.00	302	449	649
150	65.1	108	163	232		26.60	316	468	674
160	68.7	113	171	242		28.20	330	488	690
180	75.9	124	187	264			359	527	725
200	83.1	135	203	286			387	565	775
220	90.3	146	219	308			415	604	825
240	97.5	157	225	330			443	642	875
260		168	241	352			471	681	926

Fasteners Weight Chart

280	179	257	374	499	720	976
300	190	273	396	527	758	1030

How Do You Calculate The Weight Of A Bolt In Kg?

Check and find the wire diameter of the screw. Weight is calculated using this formula = $r \times r(h + \text{the estimate of the high head}) \times 0.00625$ that is of carbon steel. You can use a converter to convert the weight into kgs.

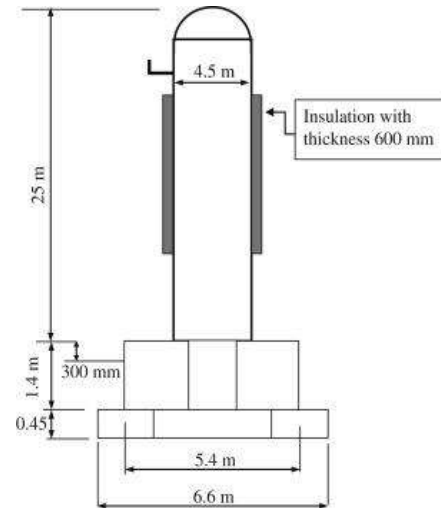

Fasteners Weight Chart

Stud Bolts And Nuts Weight Chart

Sizes	M10	M24	M52	M56	M60	M64	M27
50	24.41						
60	29.29						
70	34.17						
80	39.05						
90	43.93						
100	48.82	298.25					385.14
110	53.69	328.08	1598.22	1844.07	2273.12	2428.81	423.65
120	58.57	357.90	1743.53	2011.68	2479.78	2649.62	462.17
130	63.45	387.73	1888.83	2179.29	2686.44	2870.43	500.68
140	68.34	417.55	2034.13	2346.91	2893.10	3091.24	539.20
150	73.22	447.38	2179.43	2514.52	3099.76	3312.05	577.71
160	78.10	477.20	2324.73	2682.13	3306.42	3532.86	616.23
170	82.98	507.03	2470.03	2849.75	3513.08	3753.67	654.74
180	87.86	536.86	2615.33	3017.36	3719.74	3974.47	693.25
190	92.74	566.68	2760.64	3184.98	3926.40	4195.28	731.77
200	97.62	596.51	2905.94	3352.59	4133.06	4416.09	770.28
210	102.50	626.33	3051.24	3520.20	4339.72	4636.90	808.80
220	107.38	656.16	3196.54	3687.82	4546.38	4857.71	847.31
230	112.27	685.98	3341.84	3855.43	4753.04	5078.52	885.82
240	117.15	715.81	3487.14	4023.04	4959.70	5299.33	924.34
250	122.03	745.63	3632.44	4190.66	5166.36	5520.14	962.85
260	126.91	775.46	3777.75	4358.27	5373.02	5740.95	1001.37
270	131.79	805.28	3923.05	4525.88	5579.68	5961.76	1039.88
280	136.67	835.11	4068.35	4693.50	5786.34	6182.57	1078.39
290	141.55	864.93	4213.65	4861.11	5993.00	6403.38	1116.91
300	146.43	894.76	4358.95	5028.72	6199.66	6624.18	1155.42
310	151.31	924.59	4504.25	5196.34	6406.32	6844.99	1193.93
320	156.19	954.42	4649.55	5363.95	6612.98	7065.80	1232.44
330	161.07	984.25	4794.86	5531.57	6819.64	7286.61	1270.95
340	165.95	1014.08	4940.16	5699.18	7026.30	7507.42	1309.46
350	170.83	1043.91	5085.46	5866.79	7232.96	7728.23	1347.97
360	175.71	1073.74	5230.76	6034.41	7439.62	7949.04	1386.48
370	180.59	1103.57	5376.06	6202.02	7646.28	8169.85	1424.99
380	185.47	1133.40	5521.36	6369.63	7852.94	8390.66	1463.50
390	190.35	1163.23	5666.66	6537.25	8059.60	8611.47	1502.01
400	195.23	1193.06	5811.97	6704.86	8266.26	8832.28	1540.52

Fasteners Weight Chart

Sizes	M30	M33	M36	M39	M12	M16	M18
50					35.94	65.68	81.86
60					43.13	78.82	98.23
70					50.32	91.95	114.61
80					57.50	105.08	130.98
90					64.69	118.22	147.35
100					71.88	131.35	163.72
110	516.36	634.71	751.66	893.19	79.06	144.49	180.11
120	563.30	692.41	819.99	974.39	86.25	157.63	196.47
130	610.24	750.11	888.32	1055.59	93.44	170.76	212.84
140	657.18	807.81	956.66	1136.79	100.63	183.90	229.21
150	704.12	865.51	1024.99	1217.99	107.81	197.03	245.56
160	751.06	923.21	1093.32	1299.19	115.00	210.17	261.96
170	798.01	980.91	1161.65	1380.39	122.19	223.31	278.33
180	844.95	1038.62	1229.99	1461.59	129.38	236.44	294.71
190	891.89	1096.32	1298.32	1542.79	136.57	249.57	311.08
200	938.83	1154.02	1366.65	1623.99	143.75	262.71	327.45
210	985.77	1211.72	1434.98	1705.19	150.94	275.84	343.82
220	1032.71	1269.42	1503.32	1786.39	158.13	288.98	360.19
230	1079.66	1327.12	1571.65	1867.59	165.32	302.12	376.57
240	1126.60	1384.82	1639.98	1948.78	172.50	315.25	392.94
250	1173.54	1442.52	1708.31	2029.98	179.69	328.39	409.31
260	1220.48	1500.22	1776.65	2111.18	186.88	341.52	425.68
270	1267.42	1557.92	1844.98	2192.38	194.07	354.66	442.06
280	1314.36	1615.62	1913.31	2273.58	201.25	367.79	458.43
290	1361.31	1673.32	1981.64	2354.78	208.44	380.93	474.80
300	1408.25	1731.03	2049.98	2435.98	215.63	394.06	491.17
310	1455.19	1788.74	2118.32	2517.18	222.82	407.19	507.54
320	1502.13	1846.45	2186.66	2598.38	230.01	420.32	523.91
330	1549.07	1904.16	2255.00	2679.58	237.20	433.45	540.28
340	1596.01	1961.87	2323.34	2760.78	244.39	446.58	556.65
350	1642.95	2019.58	2391.68	2841.98	251.58	459.71	573.02
360	1689.89	2077.29	2460.02	2923.18	258.77	472.84	589.39
370	1736.83	2135.00	2528.36	3004.38	265.96	485.97	605.76
380	1783.77	2192.71	2596.70	3085.58	273.15	499.10	622.13
390	1830.71	2250.42	2665.04	3166.78	280.34	512.23	638.50
400	1877.65	2308.13	2733.38	3247.98	287.53	525.36	654.87

Fasteners Weight Chart

Sizes	M20	M22	M42	M45	M48	M72
50						
60						
70						
80	165.09	203.15				
90	185.73	228.55				
100	206.37	253.94				
110	227.01	279.33	1031.01	1195.72	1348.36	3147.88
120	247.64	304.73	1124.73	1304.43	1470.92	3434.08
130	268.28	330.12	1218.46	1413.13	1593.50	3720.29
140	288.91	355.52	1312.19	1521.83	1716.08	4006.49
150	309.55	380.91	1405.92	1630.53	1838.66	4292.70
160	330.19	406.30	1499.65	1739.23	1961.23	4578.90
170	350.82	431.01	1593.37	1847.94	2083.81	4865.10
180	371.46	457.09	1687.10	1956.64	2206.39	5151.31
190	392.11	482.49	1780.83	2065.64	2328.96	5437.51
200	412.74	507.88	1874.56	2174.04	2451.54	5723.71
210	433.37	533.27	1968.28	2282.74	2574.12	6009.92
220	454.01	558.67	2062.01	2391.45	2696.69	6296.12
230	474.65	584.06	2155.74	2500.15	2819.27	6582.33
240	495.28	609.46	2249.47	2608.85	2941.85	6868.53
250	515.92	634.85	2343.20	2717.55	3064.43	7154.73
260	536.56	660.24	2436.92	2826.25	3187.01	7440.94
270	557.19	685.64	2530.65	2934.96	3309.58	7727.14
280	577.83	711.03	2624.38	3043.66	3432.16	8013.35
290	598.47	736.43	2718.11	3152.36	3554.73	8299.55
300	619.11	761.82	2811.83	3261.06	3677.31	8585.75
310	639.75	787.21	2905.55	3369.76	3799.89	8871.96
320	660.39	812.60	2999.27	3478.46	3922.47	9158.16
330	681.03	837.99	3092.99	3587.16	4045.05	9444.37
340	701.67	863.38	3186.71	3695.86	4167.63	9730.57
350	722.31	888.77	3280.43	3804.56	4290.21	10016.77
360	742.95	914.16	3374.15	3913.26	4412.79	10302.98
370	763.59	939.55	3467.87	4021.96	4535.37	10589.18
380	784.23	964.94	3561.59	4130.66	4657.95	10875.38
390	804.87	990.33	3655.31	4239.36	4780.53	11161.59
400	825.51	1015.72	3749.03	4348.06	4903.11	11447.79

Fasteners Weight Chart

Check Weight Of Threaded Rod Per Meter

Weight per Meter	Sizes (Milimeter)	Weight per Meter	Sizes in Inches(UNC)
0.0187	M2		
0.030	M2.5		
0.044	M3		
0.060	M3.5		
0.078	M4		
0.124	M5		
0.177	M6	0.194	¼
0.319	M8	0.323	5/16
0.500	M10	0.469	3/8
		0.650	7/16
0.725	M12	0.896	½
0.970	M14	1.096	9/16
1.330	M16	1.342	5/8
1.650	M18		
2.080	M20	2.021	¾
2.540	M22	2.756	7/8
3.000	M24	3.638	1
3.850	M27	4.545	1 1/8
4.750	M30	5.718	1 ¼
5.900	M33	6.842	1 3/8
6.900	M36	8.281	1 ½
8.200	M39	9.726	1 5/8
9.400	M42	11.231	1 ¾
11.000	M45	13.038	1 7/8
12.400	M48	14.741	2

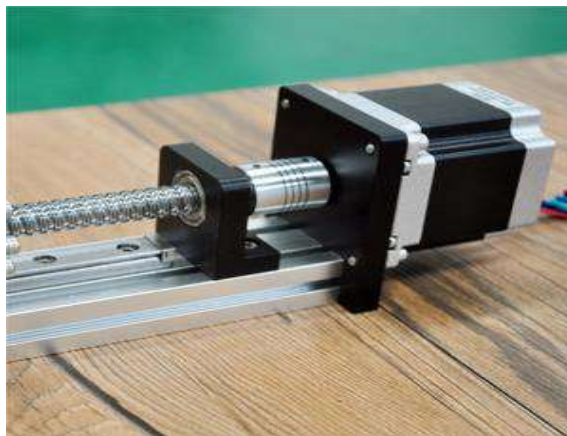

Fasteners Weight Chart

Check Online Hex Head Bolt, Washer And Machine Screw Weight Chart

Weight per Meter	Sizes (Milimeter)	Weight per Meter	Sizes in Inches(UNC)
0.0187	M2		
0.030	M2.5		
0.044	M3		
0.060	M3.5		
0.078	M4		
0.124	M5		
0.177	M6	0.194	¼
0.319	M8	0.323	5/16
0.500	M10	0.469	3/8
		0.650	7/16
0.725	M12	0.896	½
0.970	M14	1.096	9/16
1.330	M16	1.342	5/8
1.650	M18		
2.080	M20	2.021	¾
2.540	M22	2.756	7/8
3.000	M24	3.638	1
3.850	M27	4.545	1 1/8
4.750	M30	5.718	1 ¼
5.900	M33	6.842	1 3/8
6.900	M36	8.281	1 ½
8.200	M39	9.726	1 5/8